

SNABB Seaman

valve

Patented S.G.D.G



SN Standard version



SFA Automatic close version

For compressed air, pressurised water and other gas or fluid systems

ADVANTAGES:

- Ease of use – low maintenance
- Easy manipulation even at low temperatures up to 15 bars
- Safety system – small size – economical
- Direct and instant fluid flow

TECHNICAL SPECIFICATIONS

- Certified brass material
- Perbunan O-rings
- Special fittings on request (Viton, nitrile, ethylene, etc.)
- Standardised thread 1/4", 3/8", 1/2", 1" (GAS)
- In "purge" version, enables evacuation of air built up in front of the valve

ADVANTAGES:

Useful device for pressure tests and quickly purging systems, tanks, actuators, pistons and other pneumatic systems.

VALVES

STANDARD VERSION

STANDARD



Function 2/2

| BSP orifice | Réf. |
|-------------|------------|
| F 1/4" | SN 0813 ST |
| F 3/8" | SN 1217 ST |
| F 1/2" | SN 1521 ST |

PURGE



Function 3/2

| | |
|--------|------------|
| F 1/4" | SN 0813 PU |
| F 3/8" | SN 1217 PU |
| F 1/2" | SN 1521 PU |

MOST USED ON IS MACHINES

SN - STANDARD

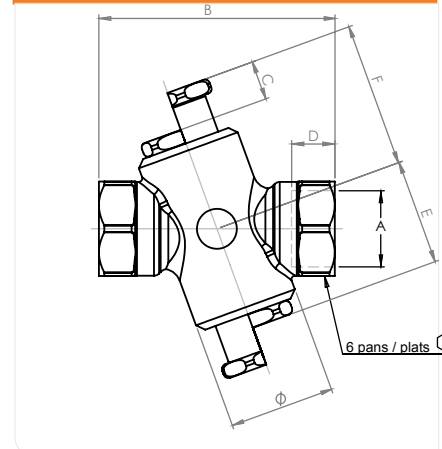

ST - PU TYPE

AUTOMATIC CLOSE VERSION

STANDARD



Function 2/2

| Orif. BSP | Réf. |
|-----------|-------------|
| F 1/4" | SFA 0813 ST |
| F 3/8" | SFA 1217 ST |
| F 1/2" | SFA 1521 ST |

PURGE



Function 3/2

| | |
|--------|-------------|
| F 1/4" | SFA 0813 PU |
| F 3/8" | SFA 1217 PU |
| F 1/2" | SFA 1521 PU |

SFA - AUTOMATIC CLOSE VERSION

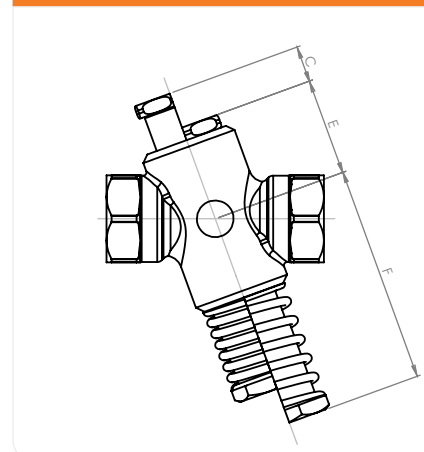

TYPE ST - PU

DIMENSIONS

| A | B | C | D | E | F | | | | Ø | ⬡ | |
|-----------------|----|----------|----|-------|----|----|-----|----|----|----|----|
| 1/4" 8 x 13 | 57 | 12 | 23 | 7 | 29 | 40 | 51 | 65 | 76 | 30 | 26 |
| 3/8" 12 x 17 | 61 | 12 | 23 | 8.5 | 29 | 40 | 51 | 65 | 76 | 30 | 26 |
| 1/2" 15 x 21 | 65 | 12 | 23 | 9 | 29 | 40 | 51 | 65 | 76 | 30 | 26 |
| | | ST | PU | ST+PU | ST | PU | ST | PU | | | |
| | | SN + SFA | | | SN | | SFA | | | | |

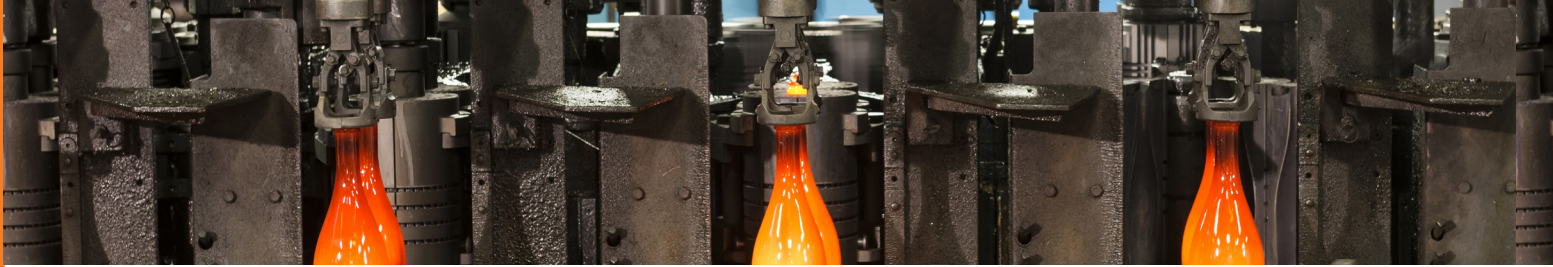

NEW OPTION: PADLOCKABLE

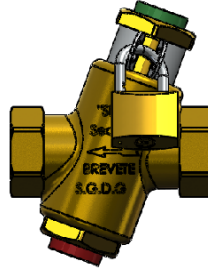
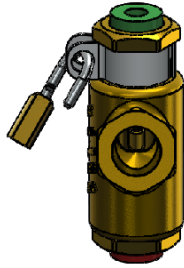
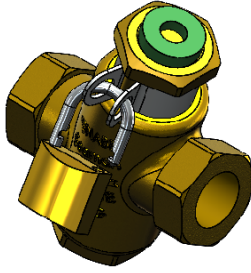

Position lock and clamp using padlock

Padlock straight through orifices



SP1511-XXX
Complete valve with locking tab

NEW OPTION: IDENTIFICATION

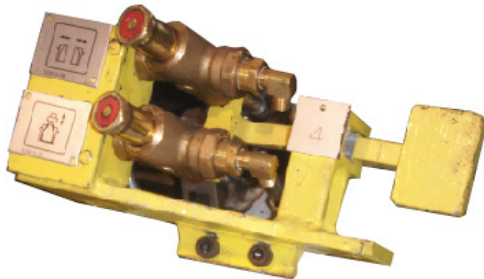

Add engraved symbols for specific function identification

OPTION: ALUMINIUM BUTTON

