

BR
Glass

A word cloud of corporate values in shades of orange and yellow. The words are arranged in a roughly circular shape. The largest words are 'Humanity', 'Trust', 'Proactive', 'Commitment', and 'Sustainable'. Other words include 'Support', 'To serve', 'Partner', 'Will', 'Quality', 'Excellence', 'Values', 'Progress', 'Cost-saving', 'Close', 'Valorising', and 'Sustainable'.

Support
Partner To serve
Humanity
Will Quality Excellence
Trust
Progress Values Proactive Valorising
Cost-saving Sustainable
Close
Commitment

Your trust is our strength

DEVELOPMENT, MANUFACTURE, AND RECONDITIONING OF INDUSTRIAL COMPONENTS

Established in 2009 in southeast France, BMR is a company specialising in the development, supply and reconditioning of standard and specific GLASS and PET industrial components.



Contact us

🏠 9 rue du Bas Taulet, 13330 Pélissanne - France

☎ +33(0)4.42.55.31.67

@ contact@bmr-industry.com

🌐 www.bmr-industry.com

Opening hours : 9am-12pm / 2-5pm



Our commitment to RSE



BMR maintains its role of helping its customers through significant industry, economic and environmental changes and commits to being their ideal partner.

BMR is one of the leaders of French industry. We partner with our customers, and we want to constantly improve our relationship with them by offering high quality products and services, better meeting their needs. The components developed and recommended by our teams are maintained and repaired in our workshops in order to ensure an almost perfect circular economy process.

Creation of



2009

Creation of the Company at Sainte Gemme, Western France

Creation of



2012

Moved to new premises measuring 100m² in South-West France and change of management

2014

Creation of the WORKSHOP

Start of specialisation in the glass industry

2010

Creation of Internal Servicing

2013

BMR's industrial excellence model places its social and environmental commitments at the heart of its strategy. BMR is proud of its ambitions and its values, so it maintains its role of helping its customers through significant industry, economic and environmental changes and commits to acting as a high quality, conscientious, transparent, innovative and proactive partner at every stage of its value chain and towards all parties involved. BMR operates sustainably and responsibly every day: by developing and protecting its human workforce, growing its contribution to the economic and social development of local communities, while implementing circular economy.



Our history

Creation of



2016

Move to new premises measuring 360m² & creation of LOGISTICS department

2018

Opened up to the Italian market

2022

Opened up to the international market

Creation of

R&D Department
Opened up to the PET industry. Started exporting in GLASS and PET

2015

Official commitment to RSE.

Acquirement of company CIAC and brand SNABB

2017

Move to new premises measures 560m² in Southeast France.

2019



VALVES

P. 7

SNABB valve	P. 8
High pressure air-blower	P. 11
Cartridges for 21 and 2-ways valve block	P. 12
Specific cartridges	P. 13
BOTTERO* cartridges	P. 13
Safety replacement valves NUMATICS*	P. 14

SPECIFIC FULL SYSTEMS

P. 15

Tilt table	P. 16
Charpy impact machine	P. 17
Test bench for standard and proportionnal valves	P. 18
Proportional valve control cabinet	P. 19
DCX2 counting, down ware, jams, and alignment system	P. 20
Improvement of the cooling case	P. 22
Burner control cabinet	P. 23

BMR SERVICES

P. 25

Reconditioning of solenoid valves	P. 26
Cylinders reconditioning	P. 28
Shock absorbers reconditioning	P. 28
Reconditioning of LINCOLN* injectors	P. 29
Reconditioning of grease pumps	P. 29
Reconditiong of all IS machine parts	P. 29
Engraved bars, labels...	P. 30
Installation of light curtains	P. 30
On site maintenance	P. 30

AIR PREPARATION

P. 31

Thumbwheel-controlled air flow limitors	P. 32
Kits for pressure regulators	P. 33

CYLINDER

P. 35

Specific dual rod cylinder for pallet ejection	P. 36
---	--------------

* BMR n'est pas une société approuvée par les marques BOTTERO, NUMATICS and LINCOLN

HOSES AND DUCTS

P. 37**Pipes and hoses specific for IS machines****P. 38****Vacuum hoses****P. 39****M0 certified ducts****P. 40**

PRODUITS DE CONTACT

P. 41**Stacker bar, Push handles, Braided discs****P. 42****Stainless steel braids and bands****P. 43****Graphite-reinforce mesh****P. 44**

MECHANICAL PARTS

P. 45**Springs and leaf springs****P. 46****Spraying plates****P. 47****Feeder supports****P. 47****Cooling plates****P. 48**

FITTINGS

P. 49**High temperature rotating fittings****P. 50****Couplers****P. 51**

ELECTRICAL COMPONENTS

P. 53**Reinforced wiring harnesses for cracking****P. 54****Reinforced high voltage wiring harnesses****P. 55****Solenoid valve control board for IS machine****P. 56****Aluminium button heads****P. 57****3-Position emergency stop buttons****P. 58**

TOOLS

P. 59**Laser guide****P. 60****Manufacture of all specific tools for IS machines and cold end****P. 61****Hinge lifter****P. 62**



ENGRAVED ALUMINIUM BARS



REINFORCED WIRING HARNESSES



METAL BUTTONS



MECHANICAL PARTS

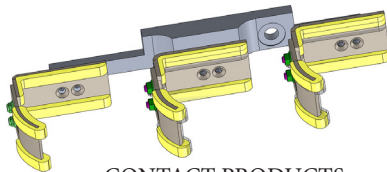

CONTACT PRODUCTS

CARTRIDGES



SHOCK ABSORBERS



CYLINDER FOR PALLET EJECTION



AIR TREATMENT

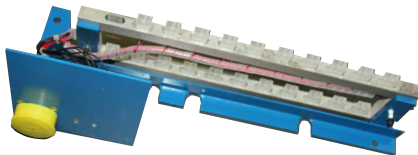

SOLENOID VALVE CONTROL BOARD AND REINFORCED HARNESSES



HOSES



VALVES RECONDITIONNING



SPECIAL TOOLS



VALVES RECONDITIONNING

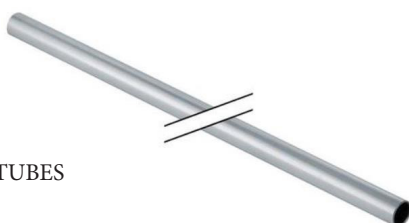

TUBES

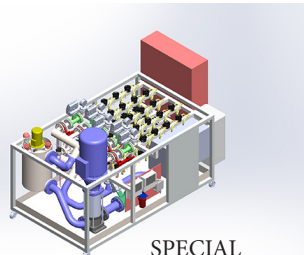

SPECIAL MACHINES



BLOWGUN

VALVES



SNABB valve

High pressure air-blower

Cartridges for 21 and 2-ways valve block

Specific cartridges

BOTTERO* cartridges

Safety replacement valves NUMATICS

*BMR is not an approved company by BOTTERO, nor an official vendor



SNABB

Seaman

valve

Patented S.G.D.G



SN Standard version



SFA Automatic close version

For compressed air, pressurised water and other gas or fluid systems

ADVANTAGES:

- Ease of use – low maintenance
- Easy manipulation even at low temperatures up to 15 bars
- Safety system – small size – economical
- Direct and instant fluid flow

TECHNICAL SPECIFICATIONS

- Certified brass material
- Perbunan O-rings
- Special fittings on request (Viton, nitrile, ethylene, etc.)
- Standardised thread 1/4", 3/8", 1/2", 1" (GAS)
- In "purge" version, enables evacuation of air built up in front of the valve

ADVANTAGES:

Useful device for pressure tests and quickly purging systems, tanks, actuators, pistons and other pneumatic systems.

STANDARD VERSION

STANDARD



Function 2/2

BSP orifice	Réf.
F 1/4"	SN 0813 ST
F 3/8"	SN 1217 ST
F 1/2"	SN 1521 ST

PURGE



Function 3/2

F 1/4"	SN 0813 PU
F 3/8"	SN 1217 PU
F 1/2"	SN 1521 PU

MOST USED ON IS MACHINES

SN - STANDARD

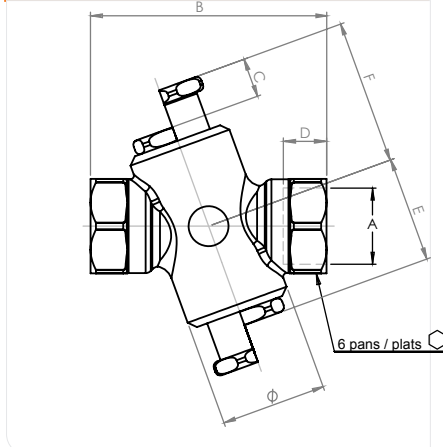

ST - PU TYPE

AUTOMATIC CLOSE VERSION

STANDARD



Function 2/2

Orif. BSP	Réf.
F 1/4"	SFA 0813 ST
F 3/8"	SFA 1217 ST
F 1/2"	SFA 1521 ST

PURGE

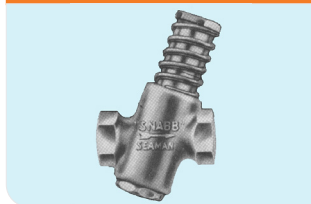

Function 3/2

F 1/4"	SFA 0813 PU
F 3/8"	SFA 1217 PU
F 1/2"	SFA 1521 PU

SFA - AUTOMATIC CLOSE VERSION

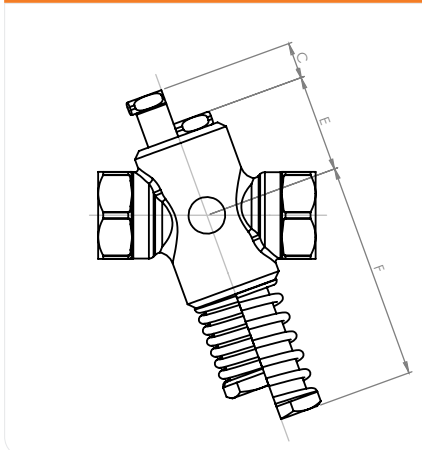

TYPE ST - PU

DIMENSIONS

A	B	C		D	E	F				Ø	
1/4" 8 x 13	57	12	23	7	29	40	51	65	76	30	26
3/8" 12 x 17	61	12	23	8.5	29	40	51	65	76	30	26
1/2" 15 x 21	65	12	23	9	29	40	51	65	76	30	26
		ST	PU	ST+PU		ST	PU	ST	PU		
		SN + SFA				SN		SFA			



NEW OPTION: PADLOCKABLE

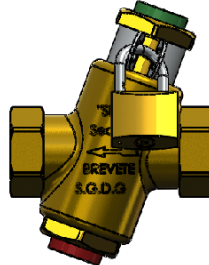
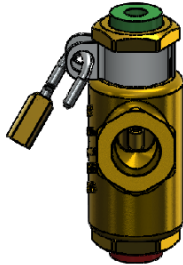
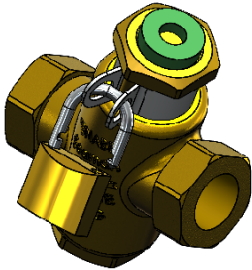

Position lock and clamp using padlock

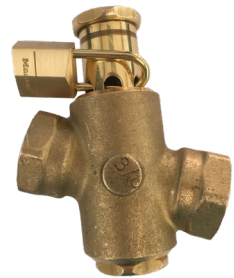

Padlock straight through orifices



SP1511-XXX
Complete valve with locking tab

NEW OPTION: IDENTIFICATION

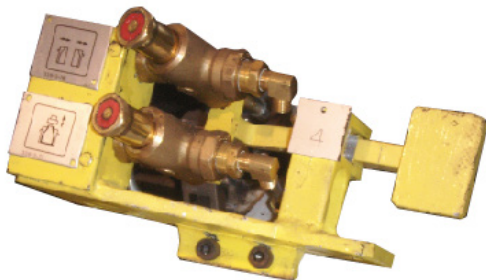

Add engraved symbols
for specific function identification

OPTION: ALUMINIUM BUTTON

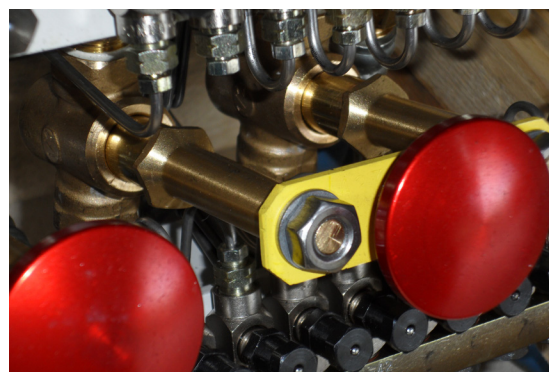
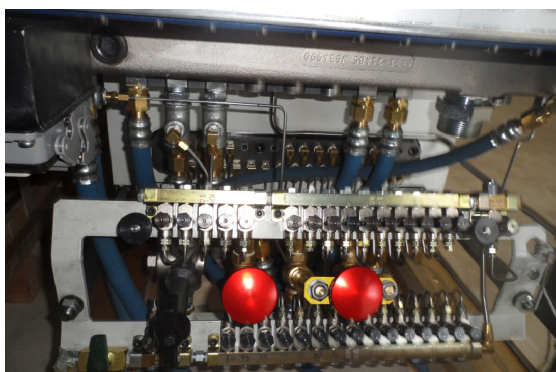

HIGH PRESSURE STRONG AND LIGHTWEIGHT COMPRESSED AIR-BLOWER

Main applications GLASSWORKS:
Replacement for existing MOULD BLOWING SYSTEMS

Can be installed on site for existing systems

ADVANTAGES :

- + Effective
- + Strong
- + Lightweight
- + Easy to hold down
- + Economical
- + Ergonomally designed

**+ SAFETY FEATURE: SHUTS OFF
WHEN THE HANDLE IS RELEASED**

TECHNICAL SPECIFICATIONS

Fluid: Compressed air or water

Maximum pressure: 12 bar

Temperature: -20°C to +100°C

Specific developments on request

DIMENSIONS

Models	Inlet	Outlet	A (mm)	B (mm)	Ø intern (mm)	Weight (g)
SO1818	1/8	1/8	22	85	3	100
SO1418	1/4	1/8	22	85	3	100
SO1414	1/4	1/4	22	85	3	100
SO3814	3/8	1/4	35	145	12	315
SO3838	3/8	3/8	35	145	12	315
SO1238	1/2	3/8	35	145	12	315
SO1212	1/2	1/2	35	145	12	315
SO1212HF	1/2	1/2	35	145	14,5	315
SO3412LF	3/4	1/2	35	145	14,5	315
SO3412	3/4	1/2	42	145	18	407
SO3434LF	3/4	3/4	35	145	14,5	315
SO3434	3/4	3/4	42	145	18	407
SO134	1	3/4	42	145	18	407
SO11	1	1	42	145	18	407

Most used by IS machines



MATERIALS

Aluminium

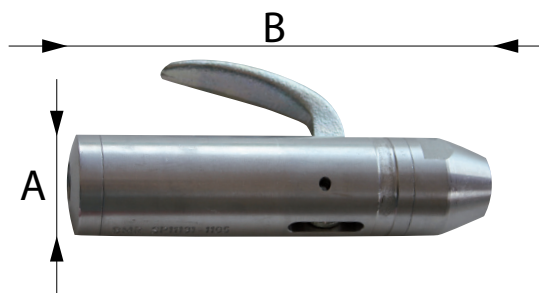

OPTIONS

Extended handle : -P



Steel tip: -ACS





CARTRIDGES FOR 21 AND 26-WAY VALVE BLOCK

Valve block cartridges with valve system
Easy to assemble and disassemble

ADVANTAGES :

- + Can be installed on site
- + Effective
- + Reliable
- + Strong
- + Economical, cheaper

Less sensitive to contamination



TECHNICAL SPECIFICATION

Cartridge: Normally open or normally closed

Colour : Red ou blue

Data may be changed without warning

MATERIALS

Anodised aluminium

MODELS

BMR Reference	Inverted colour	Colour	Normally open	Normally closed	EMHART* equivalent reference
BMR022014	✓	Red		✓	59-27241 191-7705 191-8274 59-27677
BMR012014	✓	Blue	✓		59-27242 191-7704 191-8273 59-27616
SP14NFB		Blue		✓	191-7705-1 191-8274 59-27241 59-27617
SP14NOR		Red	✓		59-27616 191-7704-1 59-27242-A 191-8273

DIMENSIONS

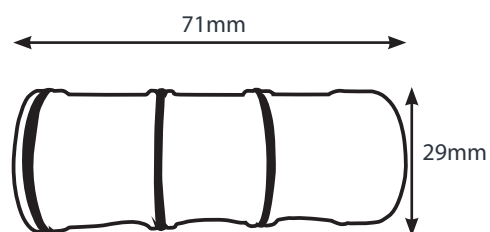

**BMR is not an approved company by EMHART, nor an official vendor*

SPECIFIC CARTRIDGES

ADVANTAGES :

- + Long lifespan
- + High flow
- + Viton fittings

Blocker available on request

REFERENCES :

BMRO-21-4088

1" NC 3-way Cartridge

BMRO-21-4076

1" 3/8" NC 3-way Cartridge



BOTTERO* CARTRIDGES

REFERENCES :

BMRBOT-A338-3-CA3

Normally Open Cartridge
Blue

BMRBOT-A338-3-CA4

Normally Closed Cartridge
Red



**BMR is not an approved company by BOTTERO, nor an official vendor*



SAFETY REPLACEMENT VALVES NUMATICS 34JDR443O011C00

ADVANTAGES :

- + On site replacement

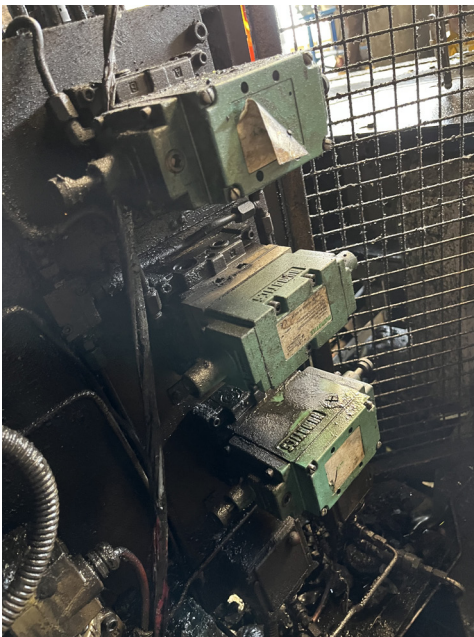

Current installations

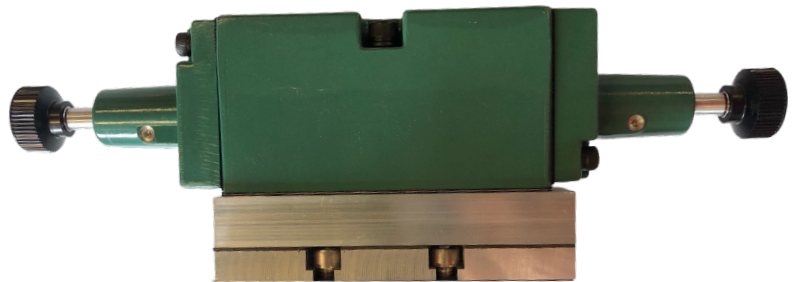

34JDR443O011C00

Pneumatically controlled valve
PA40 replaced by Numatics 55 with BMR adaptation



SP210606

MK55 valve with specific extended manual controls

**THE BMR TOUCH:
IDENTICAL ORIGINAL MANUAL
SAFETY CONTROLS**

FULL SYSTEMS



Tilt table

Charpy impact machine

Test bench for standard and proportionnal valves

Proportional valve control cabinet

**DCX2 counting, down ware, jams,
and alignment system**

Improvement of the cooling case

Bespoke burner control cabinet



TILT TABLE

The BMR tilt table is an easy-to-use device allowing operators to measure the release angle when items slide between themselves. This incline angle for containers made of glass, plastic, or metal enables the coefficient of friction to be calculated between the items.

Our device is unique thanks to its electric actuator and the precision of the laser sensor. The laser sensor features a diode and enables items to be placed closer and to detect the exact moment that the item starts to slide even with small and light objects.



TECHNICAL SPECIFICATIONS

Container size: Standard plate fits diameters between 20 and 140mm. Any other dimension can be requested.

Speed: 3 actuator speeds – 1.9, 4 or 10mm/s or speeds going from 3 to 10 degrees per second.

Table base dimensions: 350x350mm

Weight: 10kg

Specific developments on request

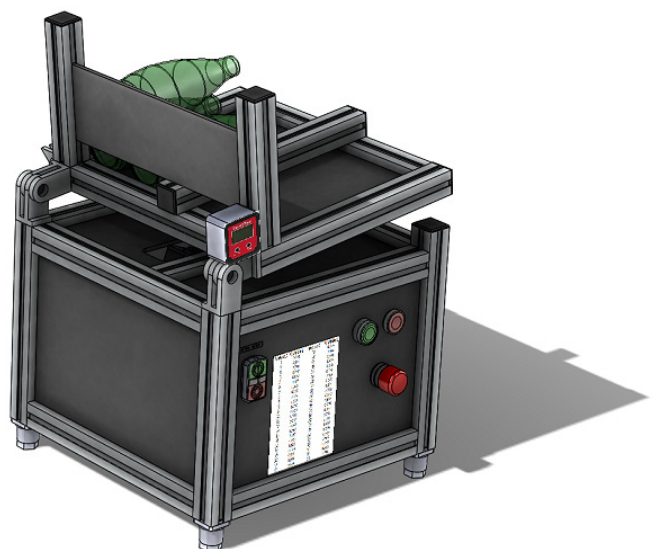

CHARPY IMPACT MACHINE

Test the resistance of a glass bottle by striking it with a pendulum hammer.

ADVANTAGES :

- + Accurate thanks to its graduated wheel
- + Magnet-locking hammer
- + Economical
- + Easy to use

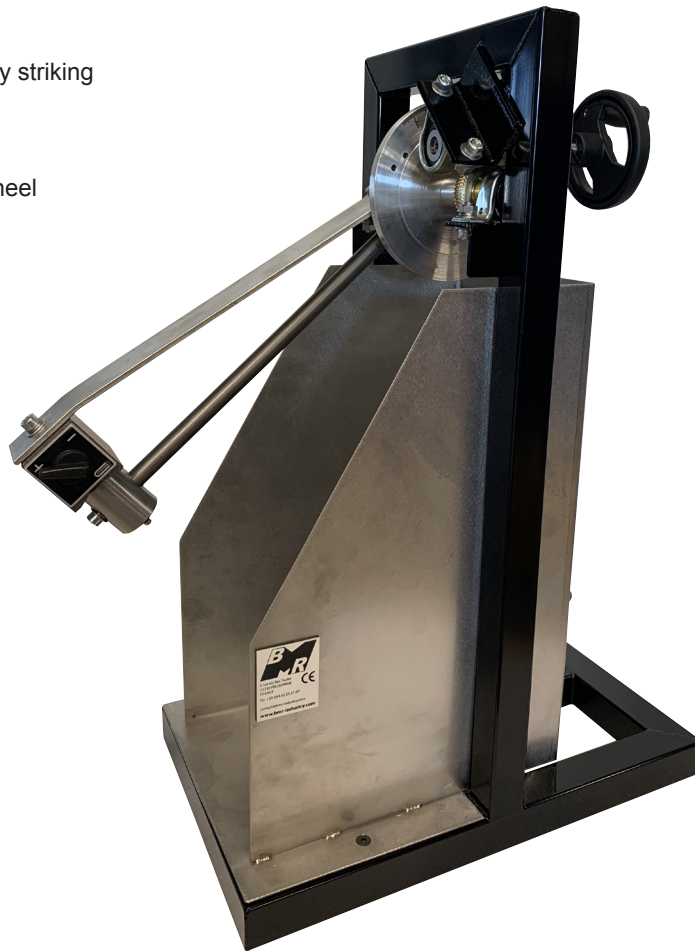

TECHNICAL SPECIFICATIONS

- Position adjustment for the height of the container being tested
- Impact speed adjustment with the strike angle
- Lockable in strike position

Specific developments on request



TEST BENCH FOR STANDARD AND PROPORTIONAL VALVES

Test all solenoid valves on a glass production machine.

ADVANTAGES :

- + Adaptability (all types of sockets and quantity desired)
- + 2 modes : manual and automatic to cycle through the valves
- + Capacity to connect an oscilloscope to obtain response times and flow rates



TECHNICAL SPECIFICATIONS

- Switch test
- Automatic cycling function
- Test for solenoid valves: standard 12 VDC / 24 VDC, proportional 4-20 mA / 0-10 Vdc and BOTTERO*
- Bespoke manufacturing available on request
- **Specific development on request**

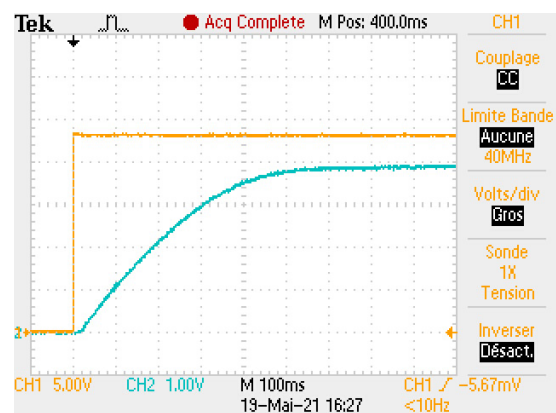
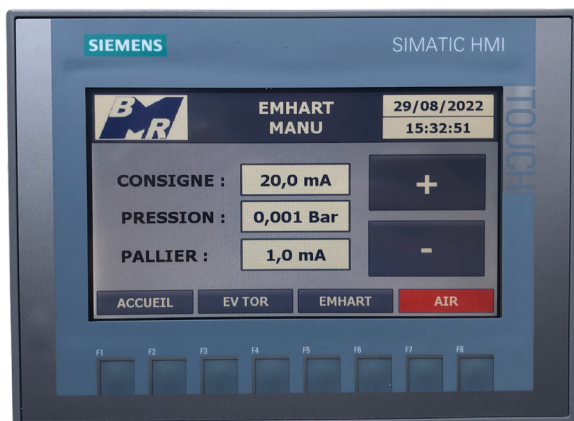

*BMR is not a company approved by brand BOTTERO, nor an official vendor

PROPORTIONAL VALVE CONTROL CABINET WITH OR WITHOUT EXHAUST SOLENOID VALVE



USAGE AND CONFIGURATION

The system allows an all or nothing pneumatic control system to be turned into a proportional controlled system.

Specific developments on request



The cycle screen displays the cycle status in real time.

The Tempo and Pressure allow for the respective values to be adjusted of time in seconds with a decimal (e.g. 1.2s or 8.7s) and pressure in bars with a decimal (e.g. 0.1 bar or 3.6 bars).

The settings are adjusted by pressing the box showing the value with your finger.



DCX2 – COUNTING, DOWN WARE, JAMS, AND ALIGNMENT SYSTEM

This new version of our item counting system is using an updated technology thanks to its infrared camera control system that gives you full control over counting as well as complete control of alignment on the conveyor.

As the system is interconnected to your IS machine, it will automatically eject any item that is unaligned, touching another item or down ware on the conveyor.

The new control interface provides an easier overview to optimally adjust your system and direct access to data using the ethernet connection, preferably, and Wi-Fi. The software is also one click away on your smartphone, tablet and computer.



FEATURES

- Item counter
- Ejects articles that are stuck/lying flat
- Ejects articles that are unaligned
- Connectivity with IS machines
- Small dimensions: 200x200x100mm

FUNCTION AND USAGE

The system has been developed in order to adapt to any needs of our customers. Our version features water cooling, which allows it to be installed in harsh locations. Our air-cooled or non-cooled versions provide considerable ease of use in certain conditions. An ease of use that, even when far from the conveyor belt, this system will provide thanks to

easy installation and user-friendly interface.

Only the settings integral to manufacture need to be adjusted by yours during production changes. Adjustments during manufacture will be able to be carried out during operation. Data are available on all devices at any moment. A connection to a global site monitoring system is also possible.

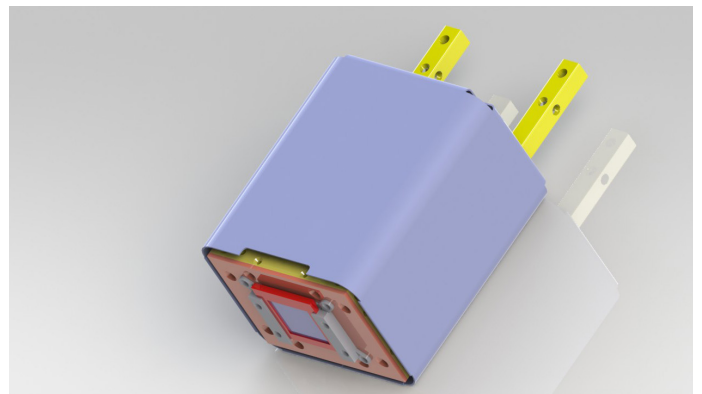
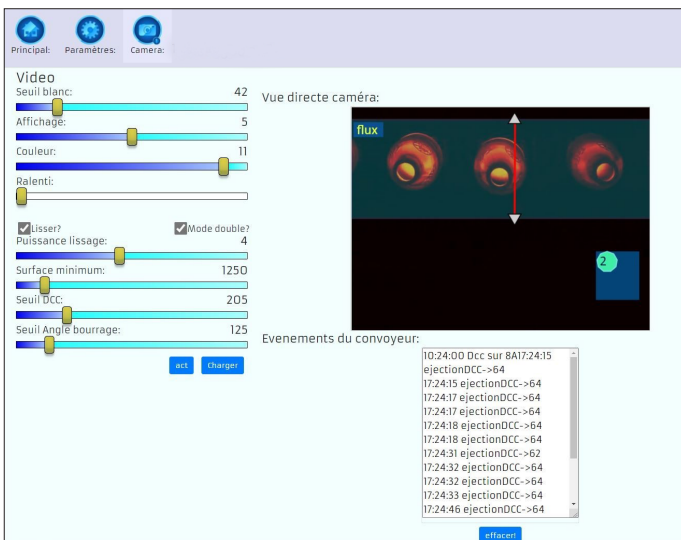

USES

Here are some examples of system usage:

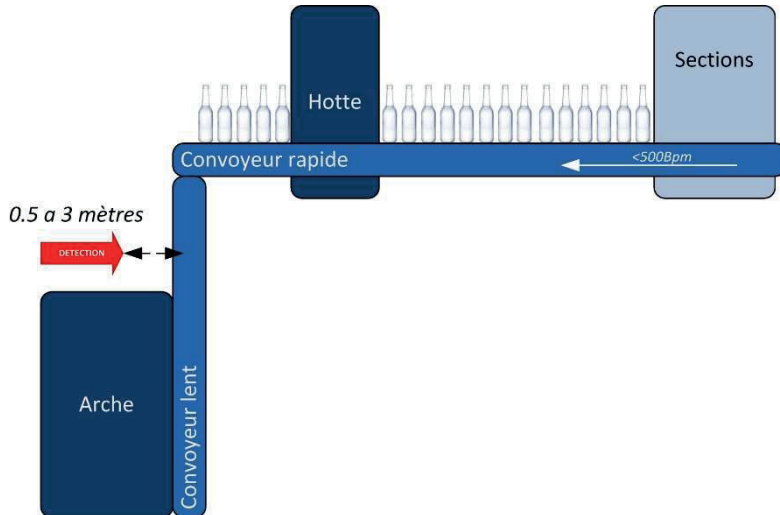

Counting : The unit is placed just at the entrance to the arch, and here the bottles can be counted immediately on leaving, there is no precise distance, in this case we can place the unit quite far away, against the arch. We could count the bottle just when they exit the last section, marking the ejected counts as pressing errors or similar.

JAMS : We can place the unit just in front of the hood, in jam mode, and it could trigger a magnetic controller or Solenoid valve, or even two. Jam is halted and the bottles are ejected to avoid the risk of jamming. We can use this mode by placing the sensor at the end of the machine, or even on the conveyor and as such detect partial or global conveyor jams.

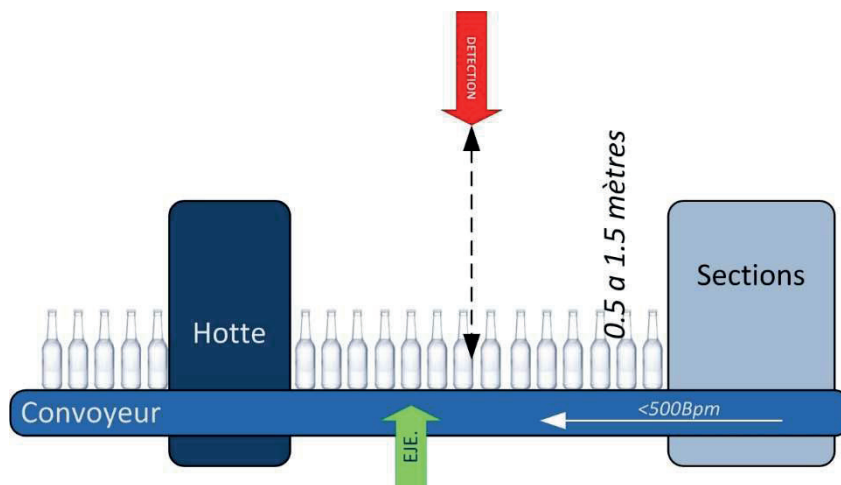
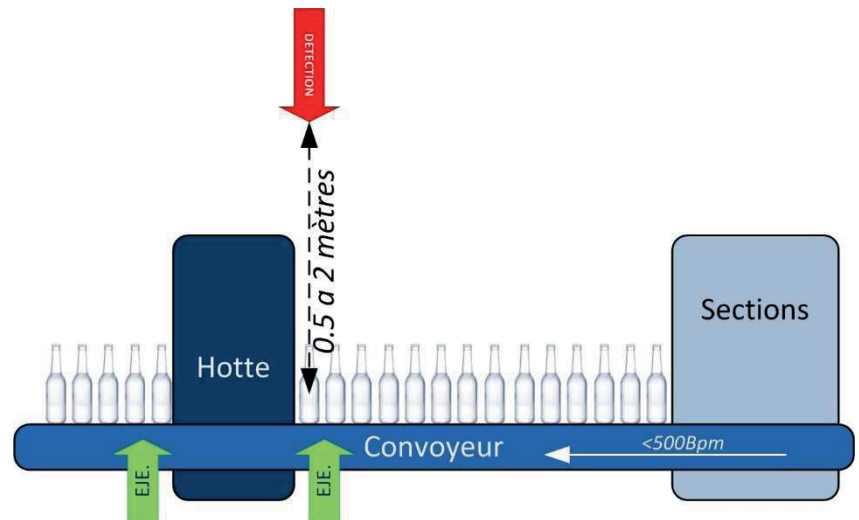

DCC Detection : As the name implies, this mode is used for ejected bottles that are stuck together or lying down, and is the most resource-intensive mode that requires the most accurate configuration. The unit must be closer to the conveyor. And the optical configuration must be set very precisely. But it will work even with cycles specific to machines that produce small, light articles (beer).

Usage is not limited to these three modes,
the equipment presented can be applied in all detection/ejection application.



IMPROVEMENT OF THE COOLING CASE ON REQUEST

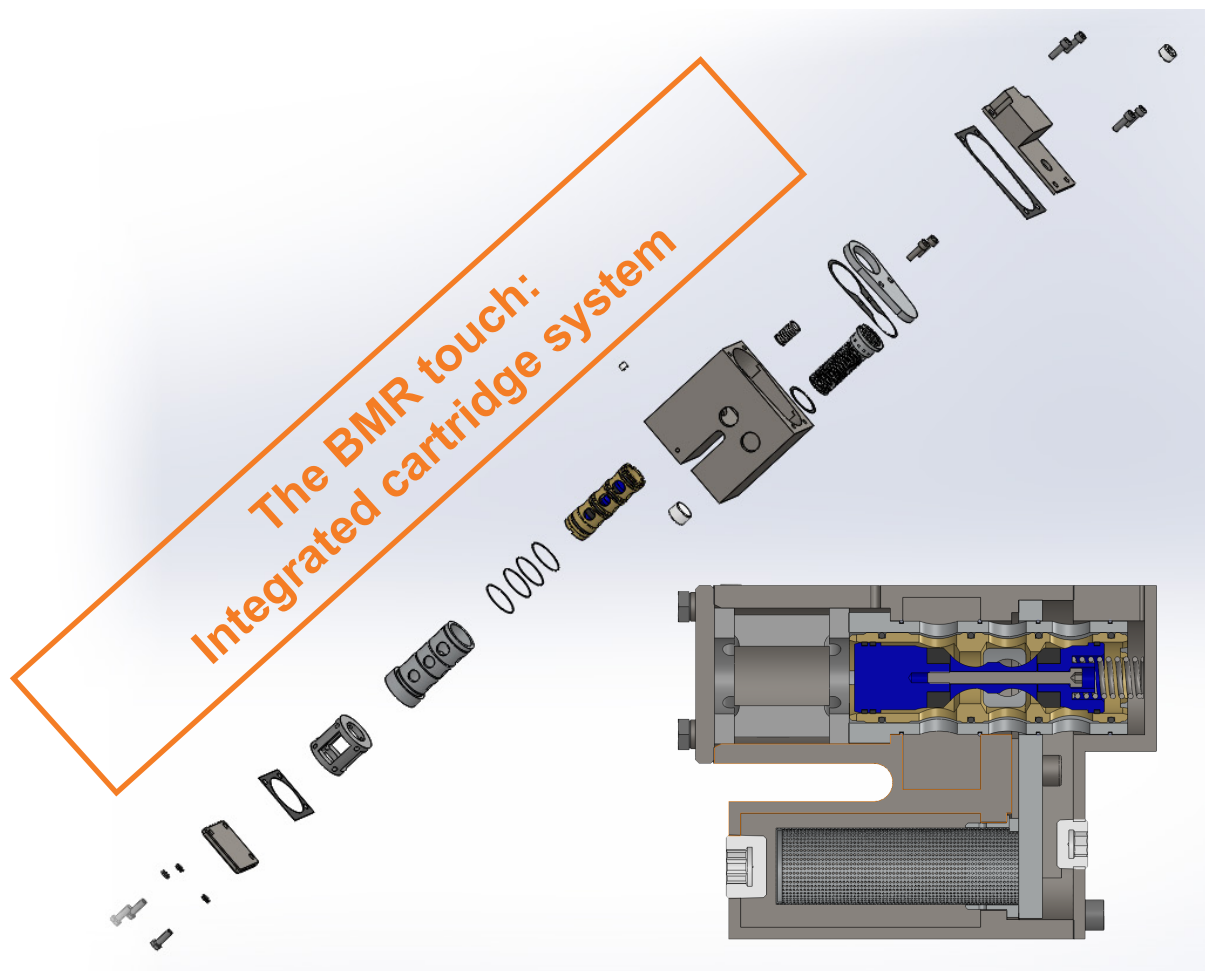

BESPOKE BURNER CONTROL CABINET

Development and manufacture of a control system for oxygen, gas and acetylene on request.

The base service includes:

- Development
- Valves, tensioners, manometers, flowmeters, control boxes, regulator, filters, tubes, etc.
- Manufacture and testing in our workshop

[illegible]

BMR SERVICES



Reconditioning of solenoid valves
Cylinders reconditioning
Shock absorbers reconditioning
Reconditioning of LINCOLN injectors
Reconditioning of grease pumps
Reconditioning of all IS machine parts
Engraved bars, labels...
Installation of light curtains
On site maintenance



RECONDITIONING SOLENOID VALVES

Reconditioning of the whole set of solenoid Valves used in the glass industry :

- Numatics (mk8, mk15 et i34)
- Ross
- Generalmatic
- Bosch
- Emhart*
- Bottero*...

ADVANTAGES :

- + Reduction in purchasing costs
- + Operating costs are reduced
- + Fewer random breakdown with traceability
- + Fewer machine stoppages



+ Economical

+ Environmentally friendly

REDUCTION IN PURCHASING COSTS

As BMR manufactures or has access to all spare parts of various manufacturers, reconditioning a solenoid valve can be much cheaper.

CONTROL OVER COMPONENT MAINTENANCE

Our package includes:

- Delivery
- Inspection and testing
- Initial exterior cleaning
- Tracking engraving
- Disassembly
- Second cleaning of all components
- Replacement of all wear parts
- Reassembly
- Pneumatic test at low and high pressure (switch test and leak test)
- Electrical test (with measurement for voltage, excitation, and de-excitation intensity)
- Written report of any remarks with tracking file

REDUCTION IN MACHINE DOWNTIME

Some solenoid valves or pilots have lead times that can go sometimes of up to 10 weeks. This, as well as the fact that many factories use the same solenoid valve or pilot references may lead to challenging situations with a section that has shut down.

Our experience allows us to recondition over 60% of "unrepairable" components, enabling the shutdown section(s) to be restarted or avoid stoppage due to lack of spare parts.

CONTROL OVER RANDOM BREAKDOWNS

When reconditioning, the solenoid valves that go through our workshops are individually engraved with two letters corresponding to the factory that they came from, followed by the number of the repaired solenoid valve. All the references, remarks before and after the reconditioning, customer figures and data (customer summary sheet detailing the exact installation location of the solenoid valve, the date, time, team that changed the valve and the reason, etc.) are stored in an Excel file. This file is supplied with the delivery note for the reconditioned solenoid valves as well as in digital format by email.

Our most common reconditioning operations for IS machines :

- Ross W7456A8332, D2173A5949, etc.
- EMHART* proportional valves
- BOTTERO* proportional valves
- ROSS proportional valves
- Numatics I34, I23, MK8, MK15 valves
- BV26 valves



BV26 Valves

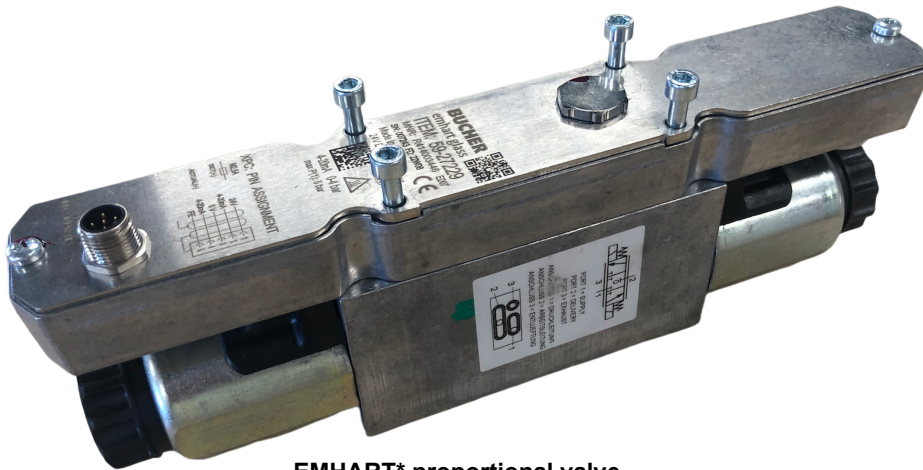

EMHART* proportional valve

BMR can also supply you with all spare parts, either standard or improved by our team:

- High temperature adhesive Socket seals specific for the glass industry
- Bespoke draws/kits
- Pistons for ROSS valves
- Components/kits for I34RS made of brass
- Kits for BV26
- Kits for ROSS D2173A5949 (+ more economical)



SP160524
I34RS piston

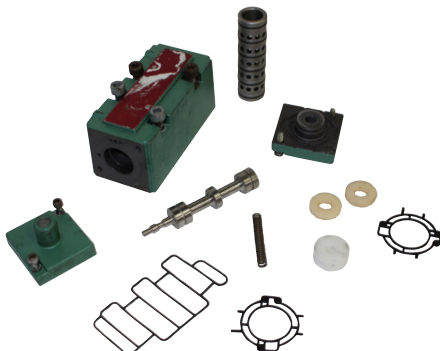

Repair kit for I34



BMRE-160427
BV26 kit

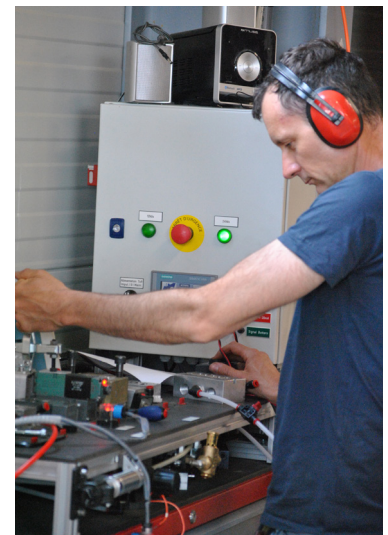

**BMR is not a company approved by brands BOTTERO and EMHART, nor an official vendor*



CYLINDERS RECONDITIONING

Reconditioning of all cylinders
used in the glass industry:

- Numatics
- Norgren
- BDF*
- Bimba
- Emhart*
- Martonair

ADVANTAGES :

- + Reduction in purchasing costs
- + Reduced operating costs
- + Fast lead time



SHOCK ABSORBERS RECONDITIONING

Reconditioning of all shock absorbers
used in the glass industry :

ADVANTAGES :

- + Reduction in purchasing costs
- + Operating costs reduced
- + Fast lead time

Mainly ex BSN and ENIDINE
(SP22287, ex. SP5695)



**BMR is not a company approved by brands EMHART and BDF, nor an official vendor*

RECONDITIONING OF LINCOLN INJECTORS



Mainly SL-42 and SL-44

Kits on request

BMR also reconditions full injector blocks

RECONDITIONING OF GREASE PUMPS

Mainly LINCOLN and GRACO



RECONDITIONING OF ALL IS MACHINE PARTS

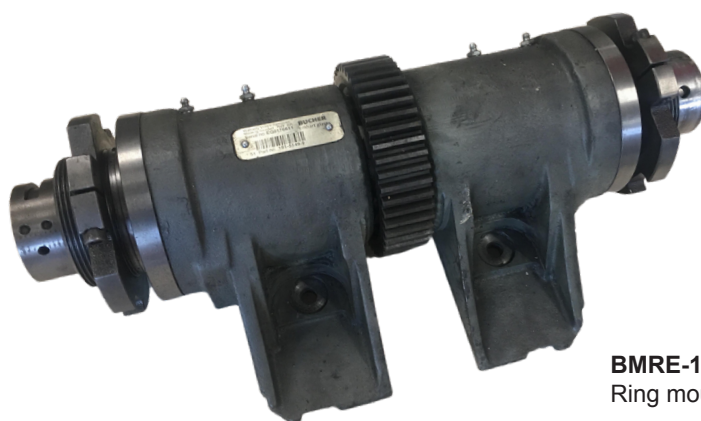

BMRE-191-5149-9
Ring mould mechanism

**+ Supply of all reconditioning parts
(depending on availability and on request)**





ENGRAVED BARS, LABELS...



BMR manufactures all types of engraved and painted plates for IS machines.



Engraving does not deteriorate over time

INSTALLATION OF LIGHT CURTAINS

Installation and configuration of light curtains

ADVANTAGES :

- + Adaptation onto existing electrical cabinets
- + Compliance with standards
- + Prior visit to site to design the best light curtain for the application



ON SITE MAINTENANCE

We offer a full range of on-site maintenance in France and in Europe

ADVANTAGES :

- + Adaptation to your environment
- + Reactivities of teams on site
- + Less stoppage time for machines



TYPES OF INTERVENTIONS

Diagnostics

- Air economy
- After sales care/Issue resolution
- Optimisation

Reconditioning

- Filters
- Valves
- SNABB

Assembly/installation of new components

Training

- On site / vidéo

AIR PREPARATION



**Thumbwheel-controlled air flow limitors
for IS machines**

Kits for pressure regulators



THUMBWHEEL-CONTROLLED AIR FLOW LIMITORS FOR IS MACHINES

ADVANTAGES :

- + On-line installation
- + Captive pin
- + Spring-lockable setting
- + Brass and aluminium construction



TECHNICAL SPECIFICAITONS

Fluid: Compressed air, filtered, lubricated/unlubricated

Operating pressure: 0.3 to 16 bar

Room temperature: -20°C to +80°C
(other models up to +150°C)

For different specifications, contact us

MATERIALS

Body, setting button and lock ring: brass

Seals: Nitrile

DIMENSIONS

Modèles	A	D max.	ø G	H	I	J	K	L	M	
SP110318	G1/8	38	5,1	8,5	8	5	24,5	27,5 max.	46	13
SP110314	G1/4	37,5	5,2	11	9,5	6	41	25 max.	60	17
SP110338	G3/8	80	8,3	17	14	-2	57	68 max.	80	25
SP110312	G1/2	80	8,3	17	16	13	57	53 max.	95	28
SP110334	G3/4	104	8,3	21,5	17,5	20,5	76	66 max.	118	32
SP110310	G1	147	13	26	24	23	90	107 max.	150	48

All specifications (sizes, fittings, etc.) are available on request

MODELS

RACC, BSPP			Max regulated flow		Flow factor	
Model	Function	Fitting	C*	CV	C*	CV
SP110318		G1/8	0,7	0,17	2,1	0,6
SP110314		G1/4	2	0,49	4,3	1
SP110338		G3/8	12	2,9	17	4,1
SP110312		G1/2	12	2,9	17	4,1
SP110334		G3/4	18	4,4	38	9,3
SP110310		G1	36	8,8	45	11

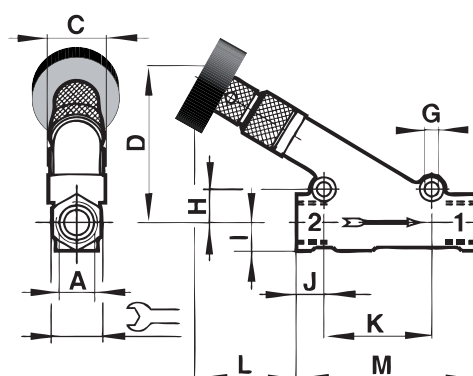

AIR PREPARATION

KITS FOR PRESSURE REGULATORS AT THE BEST PRICES



R18-100 R
R18-100V with viton seals



11-908-100

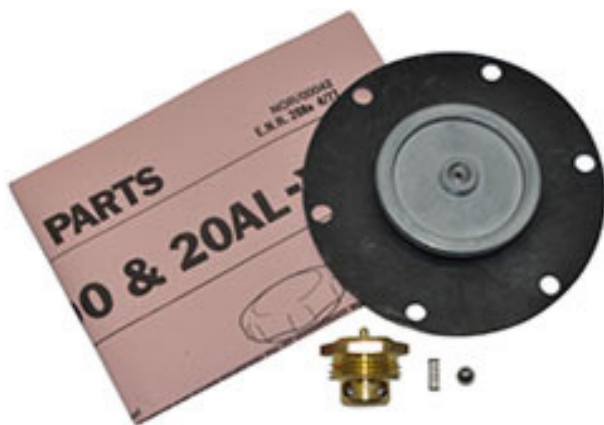

11-400-100-20AL



11-204-100

Contact us

[illegible]

CYLINDERS



Specific dual rod cylinder for pallet ejection

SPECIFIC DUAL ROD CYLINDER FOR PALLET EJECTION

The dual rod cylinder pallet ejection specific enables the glass bead to be sent to the basement if maintenance is required on a section

100% interchangeable with the Emhart cylinder ref 535-1493 standard
Stroke 125mm

ADVANTAGES:

Rod guidance:

- + Longer
- + Stronger

Piston:

- + Wide

=> Absorbs strong forces and radial impacts

==> Increased lifespan



TECHNICAL SPECIFICATIONS

Diameter: 50mm

Stroke: 125mm

Delivered with polymer damper

Specific developments on request

MATERIALS

Aluminium
Steel

DIMENSIONS

Models	Ø (mm)	Stroke (mm)	Cross rods	Polymer damper	Other options	Equivalence	Extra stroke (mm)
SP121005	50	125	✓	✓	✗	EMHART 535-1493	✗
SP140201	50	155	✓	✓	✗	EMHART 535-1493	30
SP14052	50	150	✓	✓	✗	EMHART 535-1493	25
SP14062	50	125	✓	✓	without front flange	EMHART 535-1493	✗
SP160119	50	125	✗	✗	actuators only	EMHART 535-1493	✗
SPVDHT 50125R	50	125	✗	✓	✗	EMHART 535-1493	✗

OPTIONS

- Longer course on request
- Adding of cross rods to absorb strong forces and radial impacts
- Adding the protective cover if using cross rods
- Pallet carrier

**BMR is not an approved company by EMHART, nor an official vendor*



HOSES AND DUCTS



Pipes and hoses specific for IS machines

Vacuum hoses

M0 certified ducts



PIPES AND HOSES SPECIFIC FOR IS MACHINES

THE MOST COMMONLY USED ON IS MACHINES:



P98510

Blower hose with stainless LHT1400 steel braid



P68270

Hose with acetylene stainless steel braid – 150°C pipe + LG 720mm ¼" fitting, fitted with ¼" FB



P35778

TDS LHT 900mm fitted blower head hose



P60788

DN12 800mm hose for passing electrical cables with rotating fitting for refractory wash



P436571

Blower head/blower cooling hose stainless steel DN16mm LG 1100mm



P66977

Hose for acetylene – 150°C pipe + LG 720mm ¼" fitting, fitted with ¼" FB

P42124C

Tef Conv FDV reinforced hose DN16 lg 780mm FJ 1"1/16

SP15102-3M-F-ST

Take out/inversion 3m hose + flame-retardant shielding

2TE19X29R

Reinforced hose (the BMR touch – does not get pinched when cooling/blowing)

VACUUM HOSES

Specific hose manufacturing for finishing machine vacuum

ADVANTAGES:

- + Able to reuse the tips
- + Bespoke design
- + Plug and play
- + Economical, cheaper

The BMR touch:
More economical,
able to reuse tips



TECHNICAL SPECIFICATIONS

Stainless steel hose covered with shielding and featuring tips specific for vacuum finisher

Specific developments on request

MATERIALS

Stainless steel

DIMENSIONS

Réf.	DN.	Length
BMR-FVxx	25	xx

TO ORDER

BMR-FVxx
└──────────┘ Length in dm

Example:
BMT-FV14 = vacuum hose length 1400mm



BMR-M0 - M0 CERTIFIED DUCTS



High temperature-resistant suction and ventilation hose; silicone, super light, ultra-flexible + compressible, diameter up to 1,000mm (up to 260°C)

APPLICATIONS

- For applications where non-flammable hoses are required
- For solid materials like dust, powders and fibres
- For aggressive gas environments such as vapours and fumes
- For installations performing dust removal, suction, fume suction, oven exhaust and soldering fume removal
- As a blower and compensator

SPECIFICATIONS

- Highly heat resistant
- Ultra-flexible + compressible 4:1
- Protection against abrasion using external clamping profile
- Hose wall clip in the friction resistant clamping profile
- Able to create very tight corners
- Resistant to being pierced by folding
- Lightweight
- Inflammable up to: DIN 4102-B1 – RoHS compliant

MOST USED IN THE GLASS INDUSTRY:

BMR-M0-265

Silicone duct 265mm M0

BMR-M0-275

Silicone duct 275mm M0

BMR-M0-315

Silicone duct 315mm M0

BMR-M0-330

Silicone duct 330mm M0

MATERIALS

Construction

1. Spiral support clamping profile: made entirely of stainless steel
2. Double wall; Wall: glass fibre material covered in silicone

TEMPERATURE RANGE

- -70°C to +260°C
- Temporarily up to +280°C

VARIANTS

- Other measurements and lengths available on request
- Stainless steel clamping profile
- Dual layer

TO ORDER

BMR-M0-xx

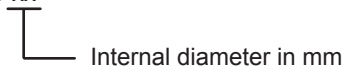

Internal diameter in mm

Example :

BMR-M0-315 = M0 duct with int. dia. Of 315mm

MOST COMMONLY USED ACCESSORIES



21201350000
Screw clamping collar



21301000000
Quick change clamping collar

CONTACT PRODUCTS



Stacker bars

Push handles

Braided discs

Stainless steel braids and bands

Graphite-reinforce mesh



STACKER BARS, PUSH HANDLES, BRAIDED DISCS...

BMR develops all types of bespoke solutions for
your bottles and perfume, etc.

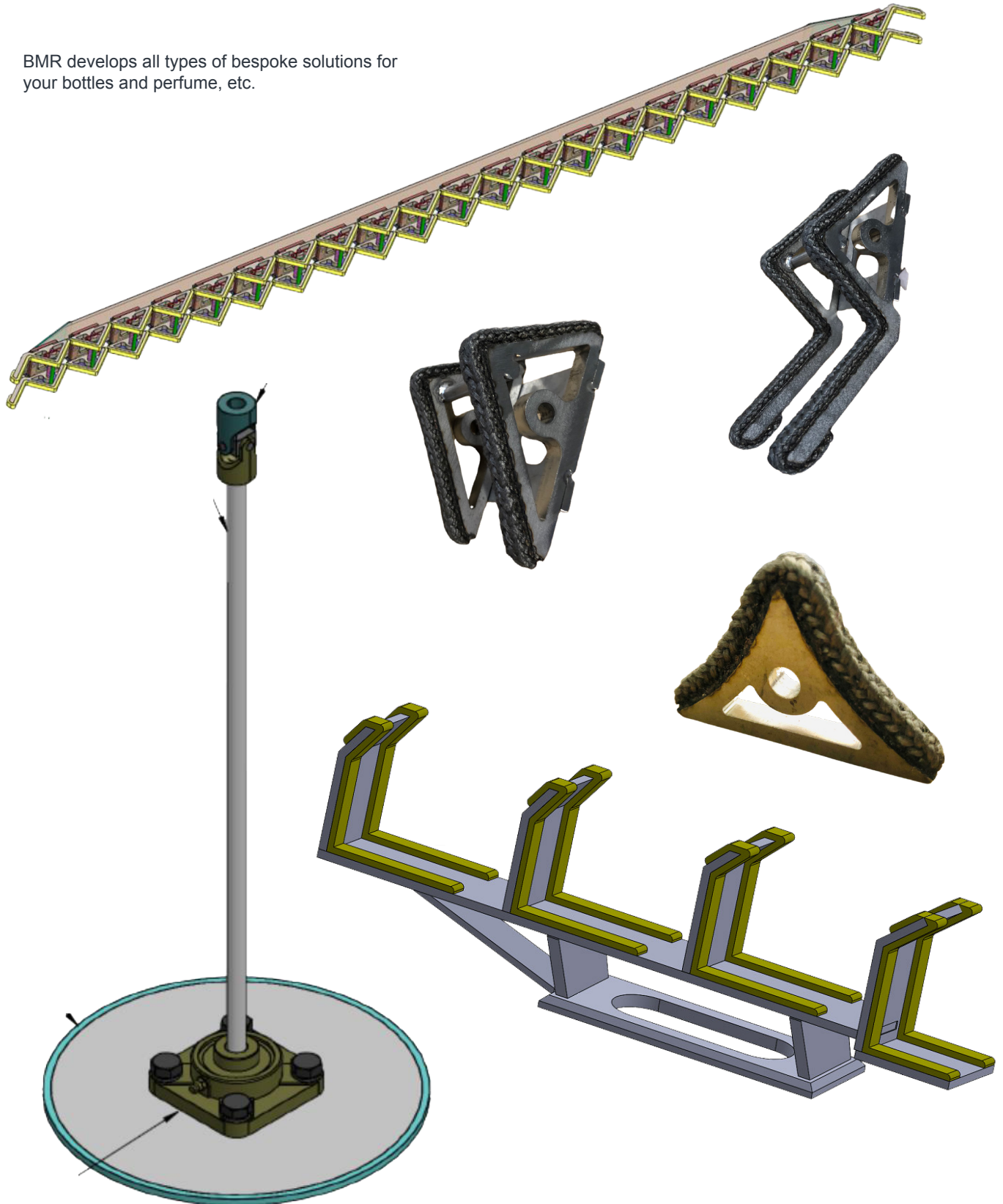

CONTACT PRODUCTS

STAINLESS STEEL BRAIDS AND BANDS

Stainless steel braids and bands are especially used for contact with hot glass on push handles, stackers and bars.

ADVANTAGES:

- + All types of developments and shapes possible
- + Very resistant to heat
- + Long lifespan
- + Avoids glazing
- + No slippage
- + Does not emit harmful dust



TECHNICAL SPECIFICATIONS

Stainless steel braids and bands
Resistant up to several hundred degrees

Specific developments on request

MATERIALS

Stainless steel
Braid 100% 3D stainless steel
Band 100% stainless steel

STAINLESS STEEL BRAIDS

Ref.	Length	Width	Thickness
BMR-TI4X4	25 m	4 mm	4 mm
BMR-TI5X5	25 m	5 mm	5 mm
BMR-TI6X3	25 m	6 mm	3 mm
BMR-TI6X6	25 m	6 mm	6 mm
BMR-TI8X8	25 m	8 mm	8 mm
BMR-TI10X10	25 m	10 mm	10 mm

For different specifications, contact us.

STAINLESS STEEL

Ref.	Length	Width	Thickness
BMR-TI25X2	100 m	25 mm	2 mm
BMR-TI30x2	50 m	30 mm	2 mm
BMR-TI40X2	50 m	40 mm	2 mm
BMR-TI50X2	25 m	50 mm	2 mm
BMR-TI60X2	25 m	60 mm	2 mm

For different specifications, contact us.

OPTIONS

All models can be made bespoke with or without support.



GRAPHITE-REINFORCE MESH FOR DEAD PLATE

Mesh composite covered with graphite that can be used as a contact material on any equipment.

- Dead or transfer plate
- Slide arm
- Transfer wheel rods
- Stacker

ADVANTAGES:

- + Complete absence of glazing when in contact with items (conclusive test at 800°C)
- + Adaptation to all supports (the material can be cut with scissors and can be folded like a fabric)
- + Low cost
- + Resistant to high temperatures
- + Very low wear because of its very high thermal dissipation capacity
- + Super-fast on-site change



Wasted time is a source of increased costs for any glass factory. This product can adapt to all applications and reduces the number of items in the warehouse, reduces the restocking time and time spent changing. Several standard versions enable it to be produced in large quantities and as such to offer a very attractive price that will ensure savings for our customers.

Standard dimensions: 30x30cm and 10x10cm (contact us for other dimensions)

MECHANICAL PARTS



Springs and leaf springs

Spraying plates

Feeder Supports

Cooling plates



SPRINGS AND LEAF SPRINGS



All types and shapes can be custom made

THE MOST COMMONLY USED ON IS MACHINES :

BMR-1911834

Leaf spring 112.7mm ring mould arm SG
diam 63mm



BMRE-235527

Leaf spring 106mm ring mould arm DG
compatible ref Emhart* 23-5527 (+ economical)



BMRE-235527-A

Leaf spring 106mm ring mould arm DG
ref Emhart* 23-5527 (identical standard version)



BMRE-235527R

Leaf spring 106mm ring mould arm DG
Stiffer ref Emhart* 23-5527 Bottero* A223-5527X



BMRE-235681

Leaf spring 128mm



BMRE-236661

Leaf spring 134mm ring mould arm
diam 83mm



BMRE-236885

Leaf spring 122mm



BMROI-16797A

Leaf spring for transfert arm 135mm reinforced



BMROI-16798

Leaf spring for transfert arm 158mm



Sale by the roll possible on request by 10 meters (Ref. BMR-L-10.55-10M-0.8)

**BMR is not an approved EMHART or BOTTERO brand company, nor an official dealer*

SPRAYING PLATES

Upon request

THE MOST COMMONLY USED ON IS MACHINES :

BMR160913

Spraying plate SE24235

BMR160913D

Modified right spraying plate

BMR160913G

Modified left spraying plate

BMR1802261D

Modified right spraying plate with 5° angle

BMR1802261G

Modified left spraying plate with 5° angle



SPRAYING FEEDER SUPPORTS FOR SCISSORS

Upon request





COOLING PLATES

Plates made on request

ADVANTAGES :

- + Improved airflow
- + Easy to install

MOST COMMONLY USED ON IS MACHINES :

SP211124-D

Straight cooling plate for IS machine blank side mold

SP211124-G

Left cooling plate for IS machine blank side mold

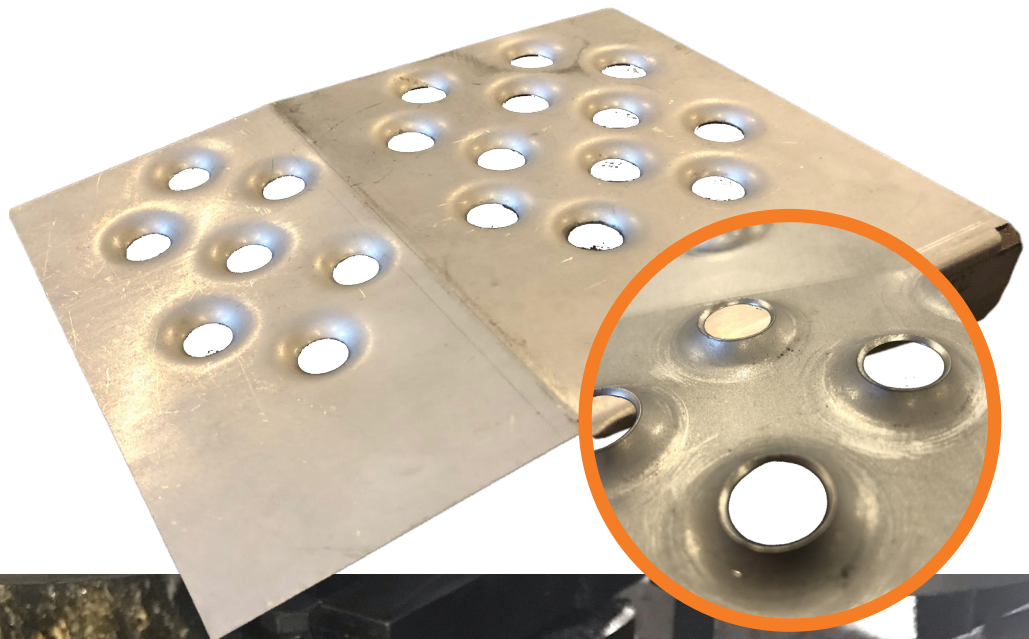

FITTINGS



High temperature rotating fittings Couplers



HIGH TEMPERATURE ROTATING FITTINGS

All types of high temperature rotating fittings, with or without ball bearings are available on request. Contact us.

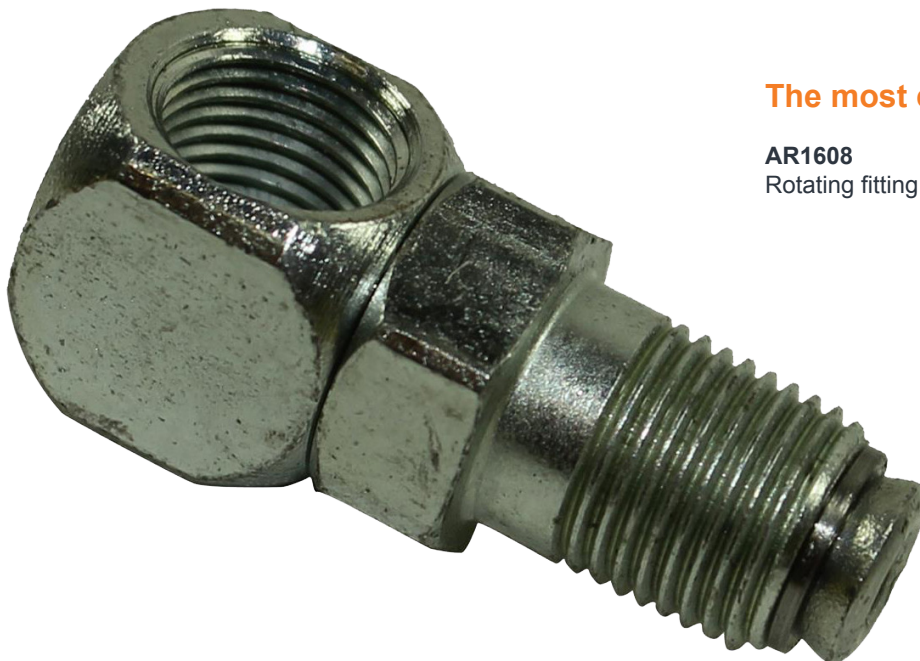

The most commonly used:

AR1608

Rotating fitting B5776 GAZ 1/8G 90D

COUPLERS

THE MOST COMMONLY USED FOR REFRACTORY WASHING:

BMR-CM-MG38-OX

Male coupler - MG3/8 RH for oxygen

BMR-CF-MG38-OX

Female coupler - MG3/8 RH for oxygen

BMR-CM-MG38-GAZ

Male coupler - MG3/8 LH for gas

BMR-CF-MG38-GAZ

Female coupler - MG3/8 LH for gas

BMR-CM-MG14-OXY

Male coupler - MG1/4 RH for oxygen

BMR-CF-FG14-OXY

Female coupler - FG1/4 RH for oxygen

BMR-CM-MG14-GAZ

Male coupler - MG1/4 LH for gas

BMR-CF-MG38-GAZ

Female coupler - MG3/8 LH for gas



ON IS MACHINES:



P380471

Male coupler 3/4
Equivalent Bottero* PI70105896



P380472

Female coupler 3/4
Equivalent Bottero* PI70105895

**BMR is not a company approved by brand BOTTERO, nor an official vendor*

[illegible]

ELECTRICAL COMPONENTS



Reinforced wiring harnesses

Solenoid valve control board for IS machine

Aluminium button heads

3-Position emergency stop buttons



REINFORCED WIRING HARNESSES SPECIAL FOR CRACKING / HIGH VOLTAGE

ADVANTAGES:

- + Resistant
- + Reliable through time
- + Lifespan
- + On-site EMHART* replacement



ADVANTAGES:

- + Resistant
- + Reliable through time
- + Lifespan
- + On-site LINDE* replacement



THE MOST COMMONLY USED:

BMR-CPHT-F-3-5

ABL connector high voltage female for cracking with cable length 3m PCS-3-761

BMR-CPHT-F-3-5-SP1

ABL connector high voltage female for cracking STRAIGHT with cable length 3m PCS-3-761

BMR-CPHT-M-1.5-5

ABL 5mm cable high voltage for cracking male connector Lg 1.5m reinforced PCS-3-763 reinforced

BMR-CPHT-M-1.5-5-SP1

ABL 5mm cable high voltage for cracking male STRAIGHT Lg 1.5m reinforced PCS-3-763



Breaking
of the original cable

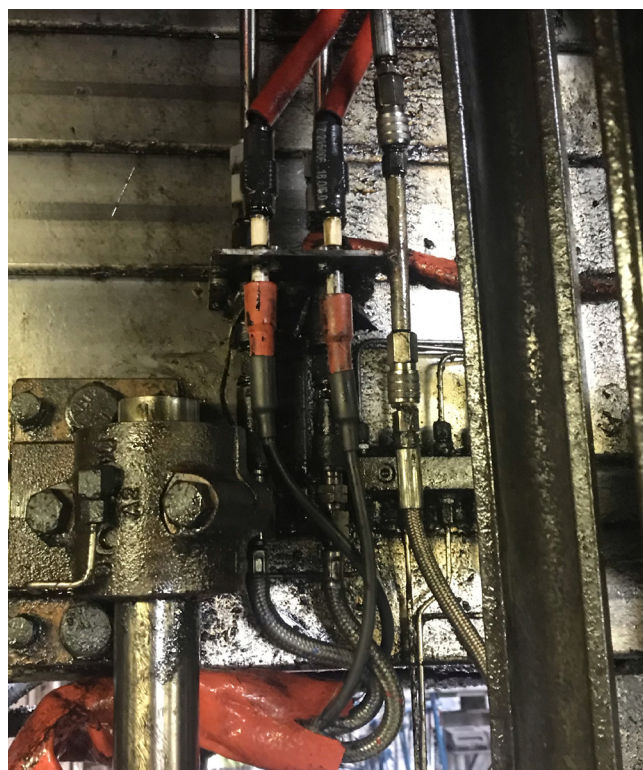

THE MOST COMMONLY USED:

SP220511

High voltage harness 1.2m with straight connector – elbow connector

SP220512

High voltage harness with 6m cable and straight connector

*BMR is not a company approved by brands EMHART and LINDE, nor an official vendor

ELECTRICAL COMPONENTS

THE MOST COMMONLY USED ON-SITE FROM EMHART:

SP1312171

Harness with 10 pin connectors, pivot cable slip arm

SP10081A

Specific harness with Harting connector for moulding block

BMROI-SCS-051-XXX

Master resolver harness SCS-051 reinforced (XXX= length)

BMROI-SCS-0652

Drop harness scoop cut

BMROI-SCS-0653

Drop harness scoop cut. High temperature resolver cable

BMROI-SCS-0659

Harness with 2x 10 pin connectors and two square solenoid valve heads

BMROI-SCS-0660

Power harness with 2 straight 4-pin connectors, 1.4m minimum reinforced

BMROI-601-5056-0120

Valve supply harness 1.2 m

BMROI-CS2-0220-GR16

Reinforced solenoid valve control harness length 5.5m

BMROI-PCS-0204

Harness for plunger sensor

BMROI-PCS-028

Reinforce funnel harness with high temperature cable and reinforced insulated shielding

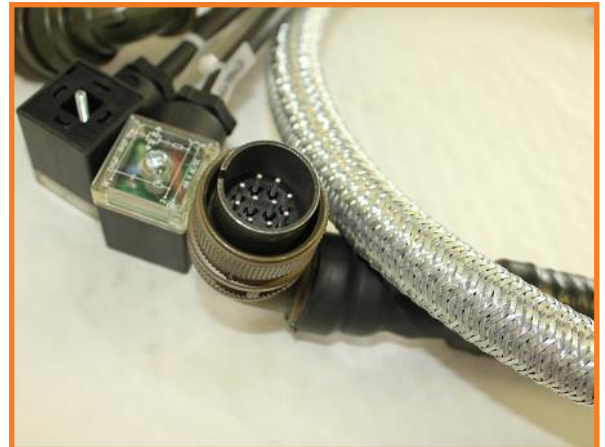

BMROI-SCS-0659



BMROI-PCS-028



SP10081A

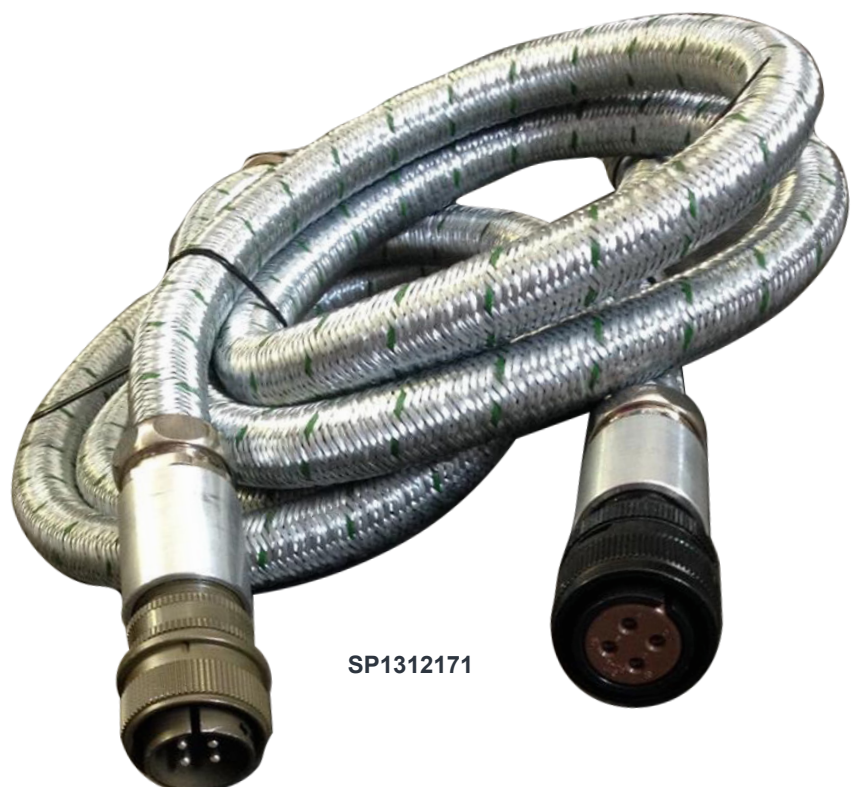

SP1312171



SOLENOID VALVE CONTROL BOARD FOR IS MACHINE BMR SP12069

The board is used for splitting the connection in order to connect several cables with cylindrical connectors to solenoid valve heads. Originally with a printed circuit, micro-solder and mini connectors, We replace the ensemble with more resistant 2-pin connectors directly connected to a single cylindrical connector.

ADVANTAGES :

- + More robust
- + Removal of connectors
- + Higher temperature resistance
- + Removal of false contacts

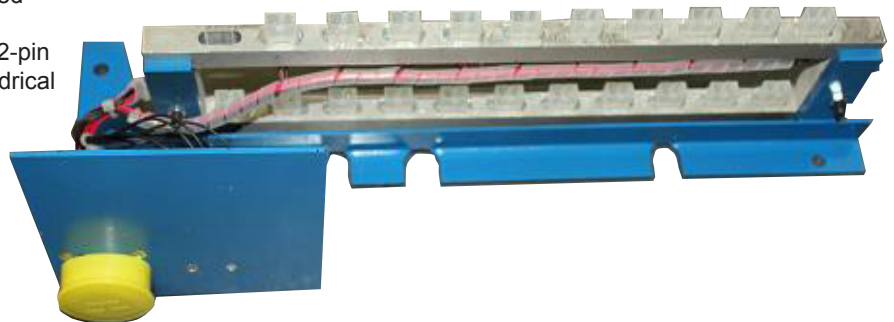

Board features exactly the same setup as L905004 with round socket

Specifications may change without warning

MATERIALS

Chassis made of folded steel with high temperature resistant blue paint
Connector support made of aluminium to lighten the structure.
High temperature wiring

**REPLACES BOARD REF L905004 FROM
O-I MACHINES**

DRAWING

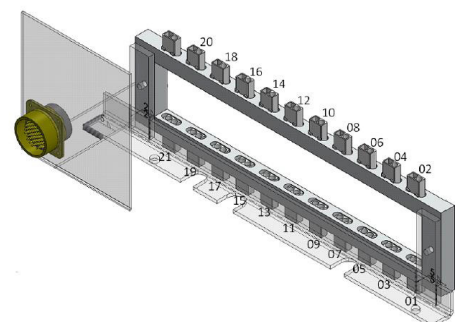
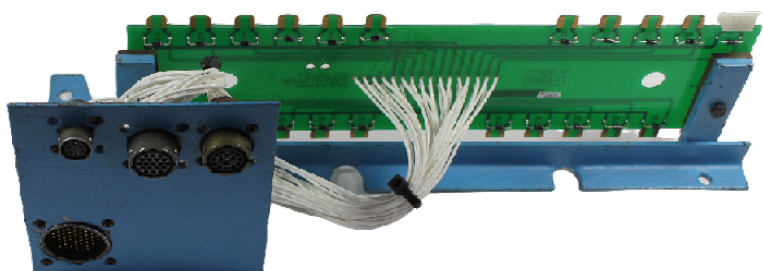

ELECTRICAL COMPONENTS

ALUMINIUM BUTTON HEADS



RECURRENT PROBLEM

Buttons "burnt" by clamps or bottles

BMR SOLUTION

Replace the plastic button head by an aluminium one

ADVANTAGES:

- + Lifespan
- + Reduction in machine downtimes
- + On-site installation with original GE P9MSM button



SP150511

Aluminium button head for GE P9MSM Emhart* finisher panel



SP160616

Aluminium button for finisher panel Emhart* one to be installed on GE P9MSM

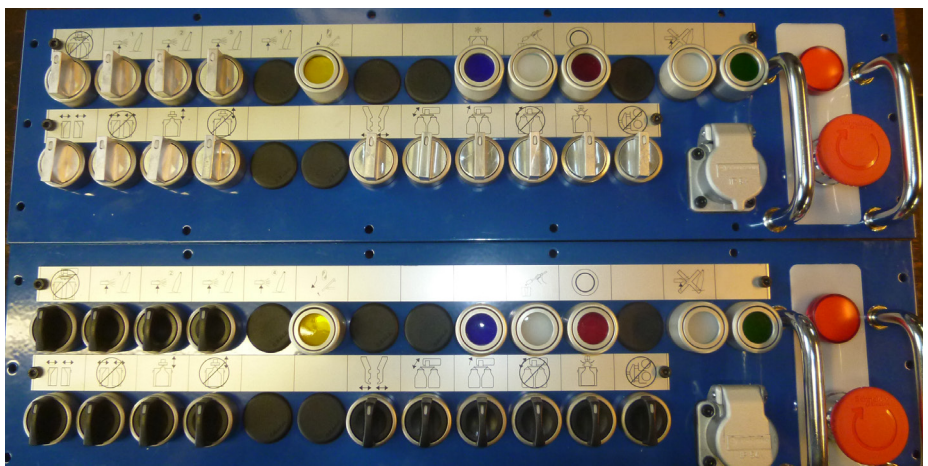

**The BMR touch:
The aluminium stem replaces
the plastic and does not melt**

**BMR is not a company approved by brand EMHART, nor an official vendor*



3-POSITION EMERGENCY STOP BUTTONS (2 fixed, 1 recall)

FUNCTION	CONTACTS	POSITION ON FLANGE		
		2	3	1
2	2 x Standard	-	X	X
3	2 x Standard	X	X	-

TECHNICAL SPECIFICATIONS

Standard button equipped with a 40mm red push button



Available as an option, the button is ergonomically designed 26mm made of red anodised aluminium
On request: reference SP12042

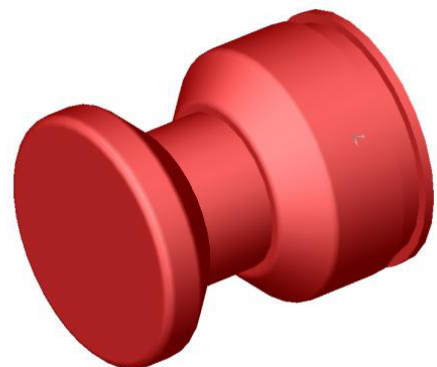

TO ORDER

Function 2 or 3
Specific flange reference + standard button: SP12041 Rev A

Standard NC contact: **187012**



TOOLS



Laser guide

**Manufacture of all specific tools
for IS machines and cold end**

Hinge lifter



LASER GUIDE

BMR-LA-25.4x100

The laser guide was designed to align the various guidance elements of the gob.



TECHNICAL SPECIFICATIONS

Diameter: 25mm
Length: 93mm
Wavelength: 634nm (red)
Target point at 10m: <10mm
ON/OFF button
Comes assembled with one CR123A battery

Specific developments on request

OPTIONS

Case with variable diameter shim

Diameter and lengths to order

MATERIALS

Button head and body
Laser diode

Aluminium
Brass

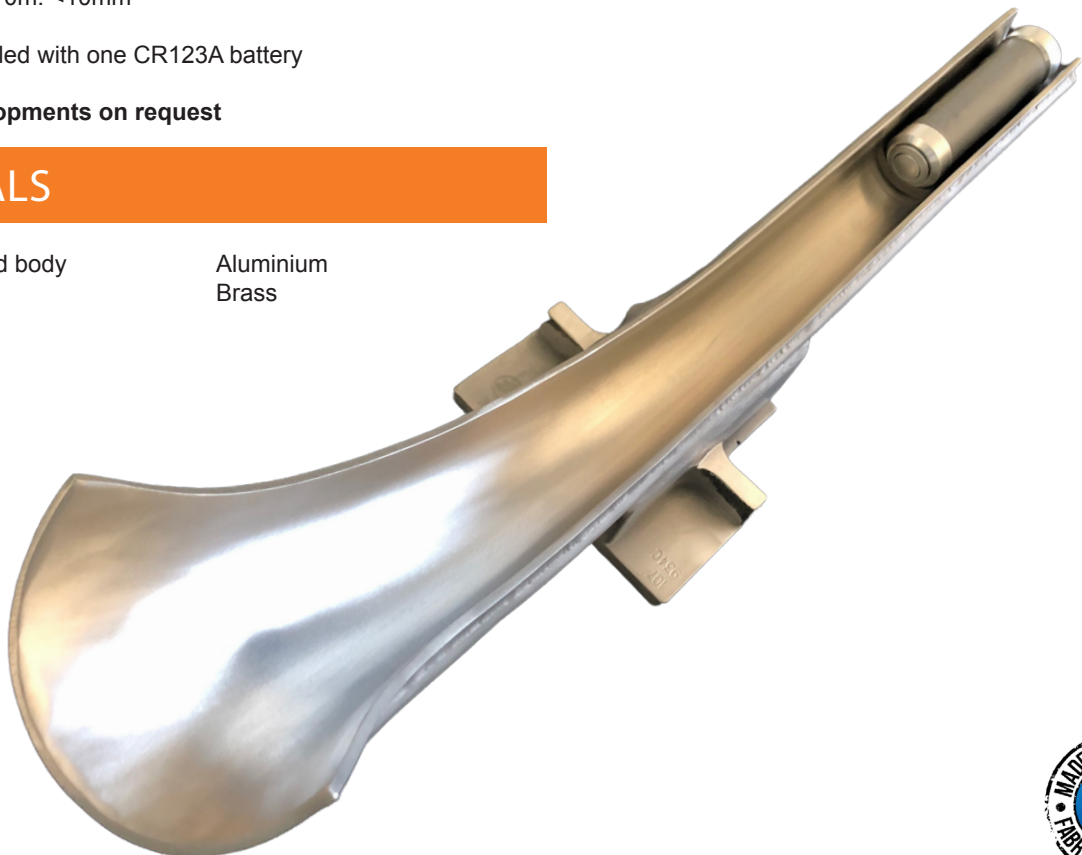

MANUFACTURE OF ALL SPECIFIC TOOLS FOR IS MACHINES AND COLD END ON REQUEST

THE MOST COMMONLY USED:



SP171007
Glass removal tongs moulding station side CLE10 new version



SP210312
Glass gripping tongs on cold end



SP171214
Solenoid insert mounting key



OUTCLECAL
Set of adjustment shims for transfer arm



OUTCLE007
Transfer arm key



OUTCLE004
Wrench for punch block adjustment -BF-



BMR-CA-1.5-0.5-2
Set of stainless-steel transfer arm adjustable shims 1.5, 0.5 and 2mm



CI346
Tube bending tool diameters 1/8" 3/16" and 1/4" (3.4 and 6mm)



OUTCLE010
Ring mould opening key

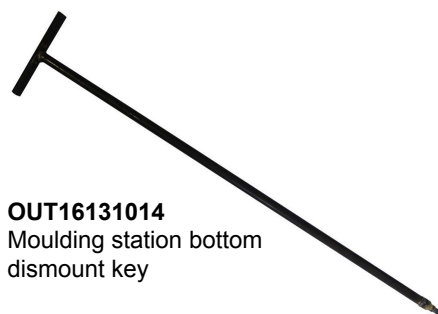

OUT16131014
Moulding station bottom dismount key



HINGE LIFTER

Specific tool for lifting hinges

ADVANTAGES:

- + Robust
- + Possibility to produce bespoke versions
- + Secure locking



TECHNICAL SPECIFICATIONS

Developed for 22 and 25mm rings
Any other version possible on request

Specific developments on request

DIMENSIONS

Réf.	Ø ring.	Max load
BMR190622-22	22.22 mm	60 kg
BMR190622-25	25.4 mm	60 kg

For different specifications, contact us.

OPTIONS

- Locking handle
- Certification
- Hooks



MATERIALS

Steel

**The BMR touch:
secure locking**



BMR-LC-22-SPL
Hinge lifter diameter
22mm
With hooks and
certification



[illegible]

Support
Partner To serve
Humanity
Will Quality Excellence
Trust
Progress Values Proactive Valorising
Cost-saving Sustainable
Close
Commitment

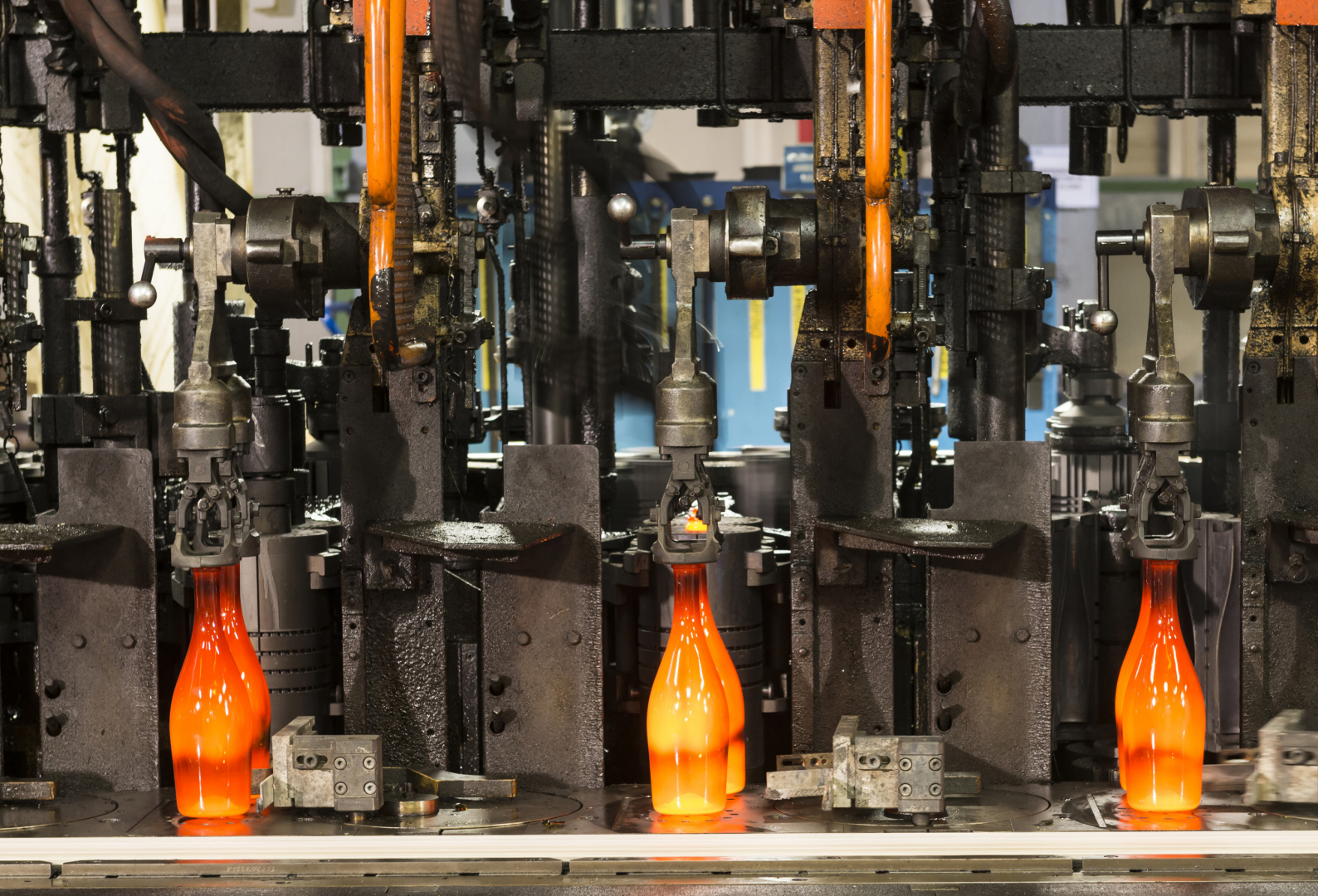

**9 rue du Bas Taulet, 13330 Pélissanne
France**

+33(0)4.42.55.31.67

contact@bmr-industry.com

www.bmr-industry.com

Opening hours: 9:00-12:00 AM / 2:00-5:00 PM
