



BMR

Tél. 04.42.55.31.67

info@bmr-france.fr - www.bmr-france.fr

VSF3130 – VSF3130/2

Stainless steel AISI 316 L relief valves,
suitable for compressed air, gas and liquid



FEATURES

Relief valve for pressure up to 50 bar (725 psi).

Inlet and outlet connections:

VSF3130 G 1" 1/2 – F

VSF3130/2 G 2" – F

by flanges screwed to the body.

Flange connections EN or ASME available on request.

The relief valve opens when the inlet pressure increases above the set point initially regulated by the adjusting screw and it closes when the pressure goes down under the set point.

Set point pressure is controlled by a piston.

Available the ATEX version

Brand  II2GDclICX.

For use in potentially explosive atmospheres zones: 1, 21, 2, 22 (not in mines and zone 0).

The product complies with the directive 97/23/CE PED.

SPECIFICATIONS

Relief valve: ~8,8 kg / ~19,4 lb for pressure up to 15 bar (217 psi)

~10,4 kg / ~22,93 lb for pressure 30 and 50 bar (435 and 725 psi)

Working temperature: -20 °C ÷ +60 °C (-4 °F ÷ +140 °F) for standard version

Degree of protection: IP25

MATERIALS

Body and bonnet: stainless steel AISI 316L

Internal parts: stainless steel AISI 316L

Adjusting spring: C85 nickel plated NiP/Fe 15 µm (not in contact with the fluid)

O-Ring: FPM (alternative compounds available on request)

Diaphragm: NBR + PTFE (PTFE in contact with the fluid)

Stainless steel AISI 316L diaphragm available on request

Piston: Stainless steel AISI 316L

Main valve gasket: FPM for pressure up to 30 bar (435 psi)

PA 6.6 for pressure up to 50 bar (725 psi)

(other compounds available on request)

ACCESSORIES

Wall mounting bracket kit: M17310

Pre-set version: factory set relief pressure

SPARE PARTS

Complete kit: main valve, diaphragm and o-rings



available model types

Relief vaves for medium pressure made of stainless steel suitable for compressed air and technical gases *Body by machining bar*

TYPE	Pin Bar	Connection IN	Connection OUT	MEDIUM
				VSF3130
VSF3130 A	0,2 – 1,5	G 1 1/2-F	G 1 1/2-F	J
				Liquid
				K
VSF3130 B	0,3 – 3	G 1 1/2-F	G 1 1/2-F	J
				Liquid
				K
VSF3130 C	0,8 – 8	G 1 1/2-F	G 1 1/2-F	J
				Liquid
				K
VSF3130 G	3 – 30	G 1 1/2-F	G 1 1/2-F	J
				Liquid
				K
VSF3130 L	5 – 50	G 1 1/2-F	G 1 1/2-F	J
				Liquid
				K
				VSF3130/2"
VSF3130/2" A	0,2 – 1,5	G 2-F	G 2-F	J
				Liquid
				K
VSF3130/2" B	0,3 – 3	G 2-F	G 2-F	J
				Liquid
				K
VSF3130/2" C	0,8 – 8	G 2-F	G 2-F	J
				Liquid
				K
VSF3130/2" G	3 – 30	G 2-F	G 2-F	J
				Liquid
				K
VSF3130/2" L	5 – 50	G 2-F	G 2-F	J
				Liquid
				K

* Air – N₂ – He – Ar – H₂ – C₃H₈ – CH₄ – CO₂

CONNECTION DIFFERENT FROM STANDARD

Inlet outlet connections NPT

Connections with flanges

EXECUTIONS DIFFERENT FROM STANDARD

Pre-set outlet pressure for outlet pressure more than 1 bar

Fixed outlet pressure for outlet pressure more than 1 bar

O-ring different from standard - EPDM

O-ring in accordance to FDA

Not standard branding

Special temperature range

Degreased for O₂

ACCESSORIES

Bracket with screws – M17310



technical drawings (all dimensions in mm)

Bracket to be ordered separately, Kit order number: M17310

TYPE	IN/OUT	FLANGE
VSF3130 2" GF	G 2-F	P37063
VSF3130 1 1/2" GF	G 1 1/2-F	P37062
VSF3130 2" NPTF	2" NPT-F	P37067
VSF3130 1 1/2" NPTF	1 1/2"NPT-F	P37066

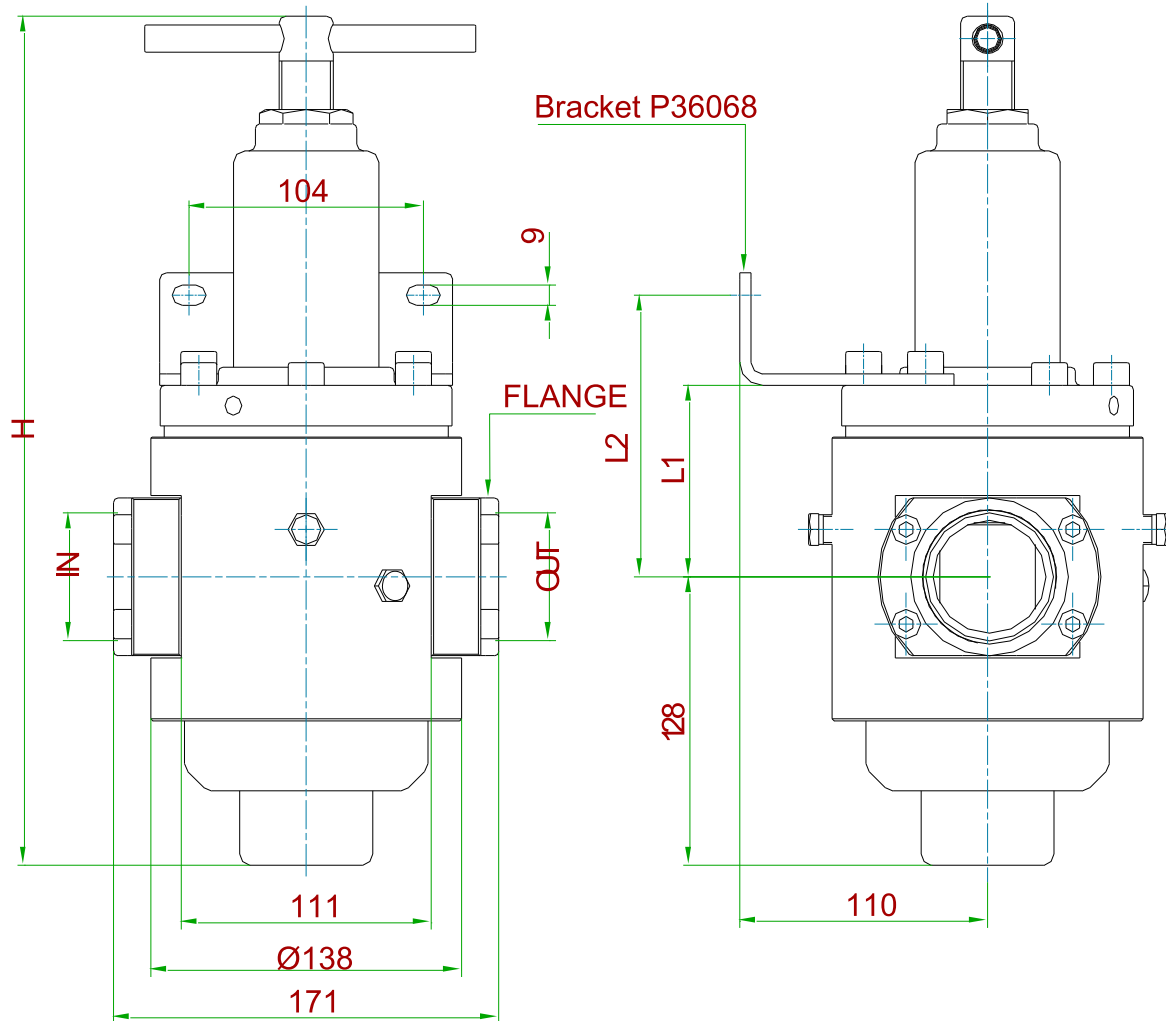

MODEL	H	L1	L2
Diaphragm (0.2÷1.5/0.3÷3/0.8÷8/1.5÷15)	~377	85	125
Piston (3÷30/5÷50)	~387	98	138